

NOTE: STRESSES ASSOCIATED WITH EXTERNAL OR ENVIROMENTAL EFFECTS HAVE NOT BEEN CONSIDERED IN THIS DESIGN.ANY PROJECT SPECIFIC LOADINGS WILL REQUIRE EVALUATION TO ENSURE THAT THEY DO NOT APPLY NEW LOADS NOT ALLOWED FOR IN THIS DESIGN.

HEF - FLEXIBLE WATER TUBE STEAM BOILER SPECIFICATIONS

MODEL: HEFe800/HEFec800
KILOWATT RATING: 2000 kW
DESIGN REFERENCE: AS1228-2010
VESSEL CLASS: 1
DESIGN PRESSURE: 1100 kPa
EVAP (from & @ 100 °C): 3190 kg/hr
INPUT: 9000 / 8600 Mj/hr
OUTPUT: 7200 Mj/hr
L.P.G.: 96.56 / 92.27 m³/hr
NATURAL GAS: 232.56 / 222.22 m³/hr
SHIPPING WEIGHT: 9200 kg
FLOODED CAPACITY: 1914 L

Note: 'ec' denotes model fitted with economiser

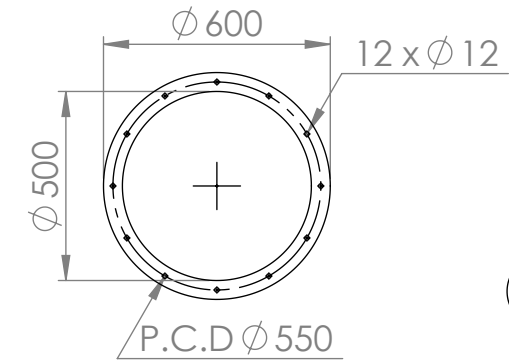

FLUE FLANGE DETAILS

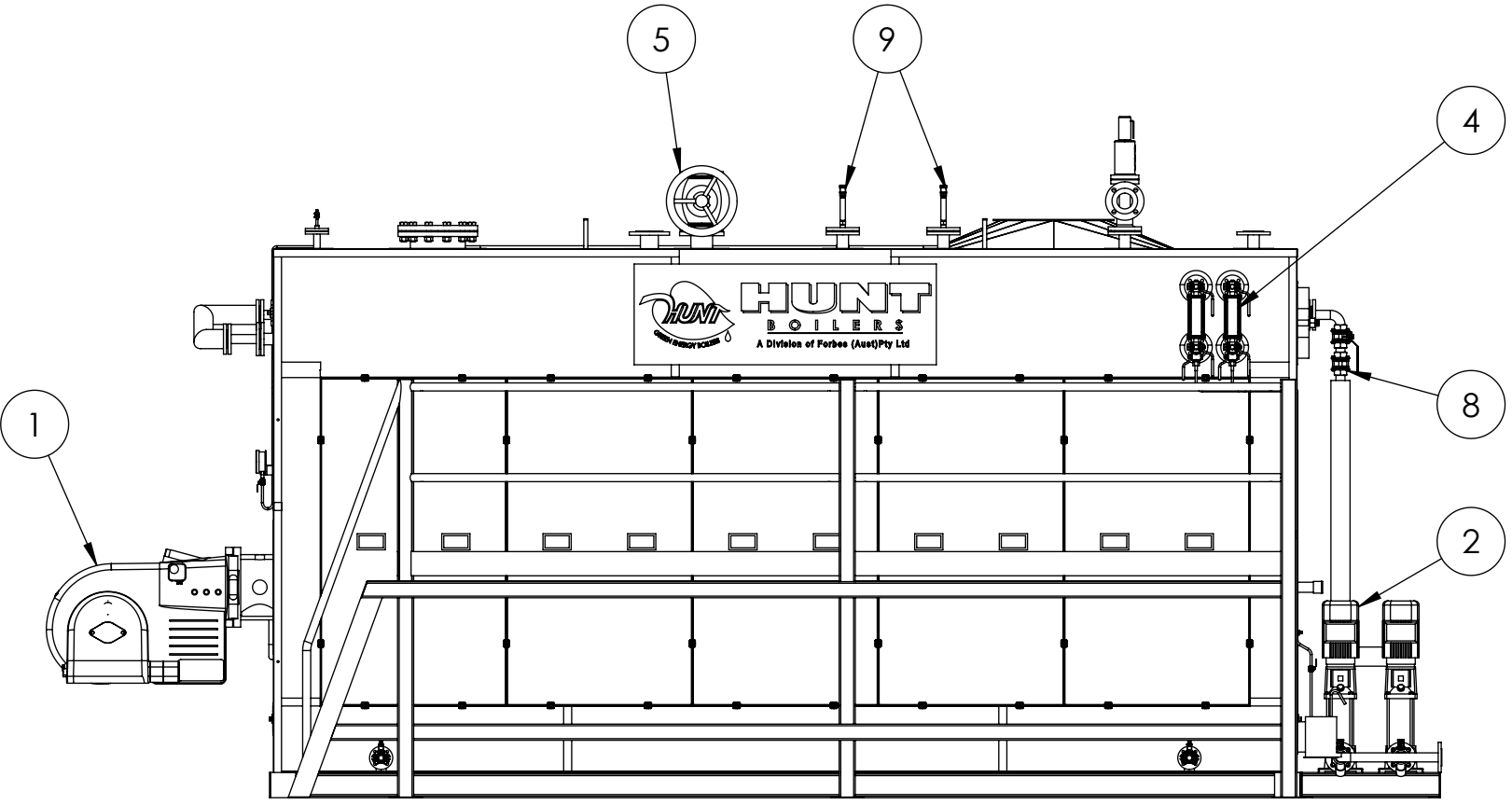
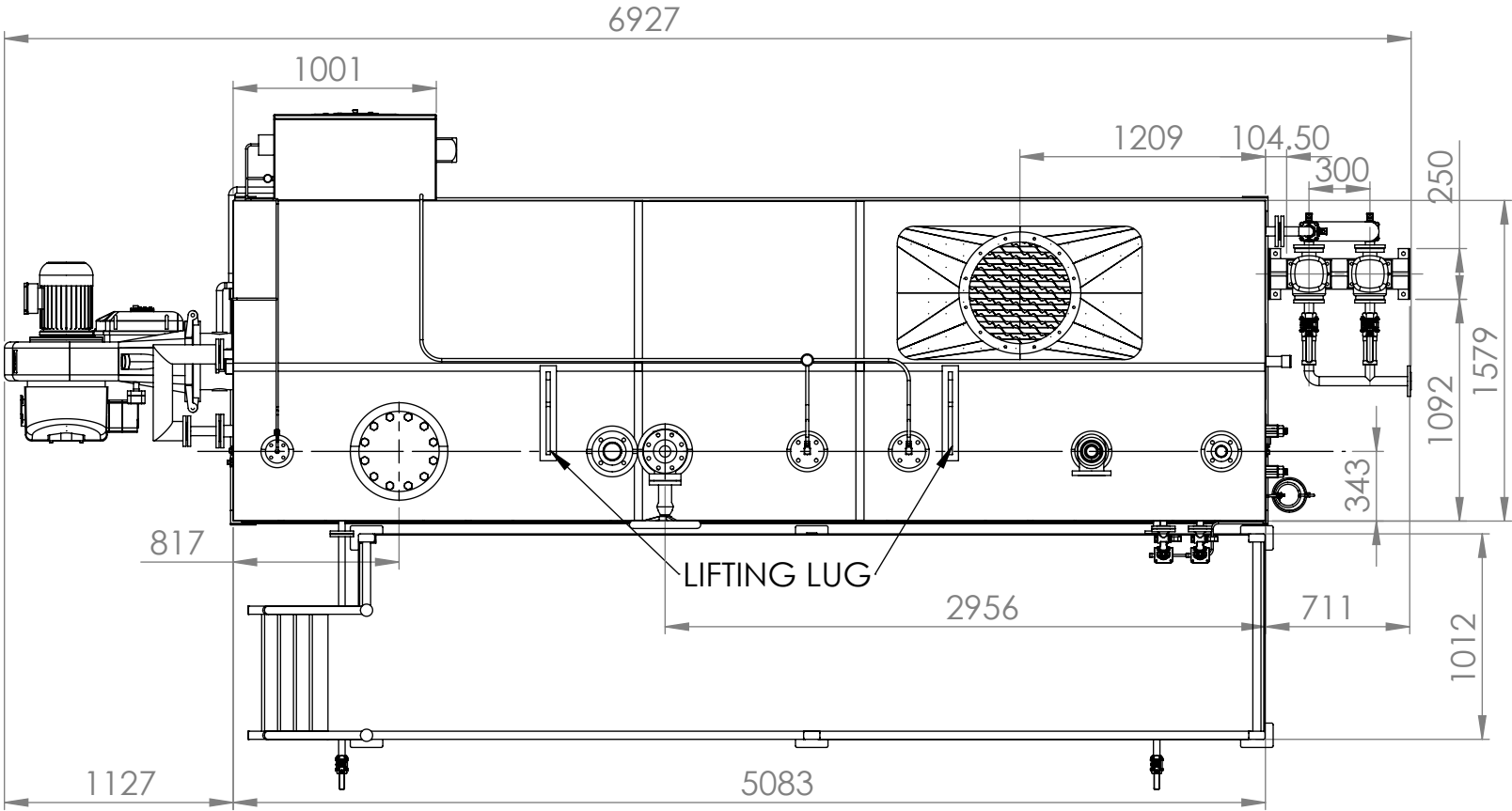
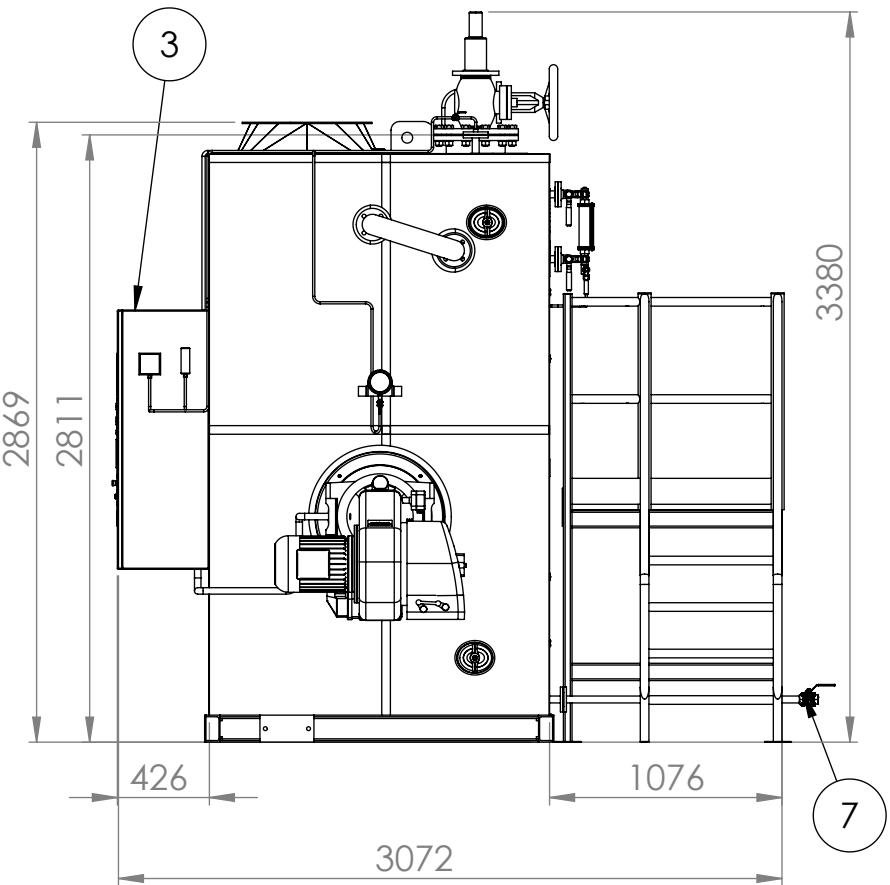

IN THE INTEREST OF CONTINUOUS IMPROVEMENT HUNT BOILERS RESERVES THE RIGHT TO CHANGE THE SPECIFICATIONS OF ITS PRODUCTS WITHOUT PRIOR NOTICE.